

Eoghan Byrne,
Leitrim,
Edenderry,
Co. Offaly

POSTAL ADDRESS

Building 3400,
Cork Airport Business Park,
Rathmacullig West
Cork
T12 AE76

PHONE

(021) 242 7786

INTERNET

www.statkraft.ie

EMAIL

post@statkraft.com

Date:

Re: Planning Application by Ballinla Wind Farm Limited for a Renewable Energy Project on lands in the townlands of Leitrim, Ballyleakin, Ballyfore Big, and Ballina (Geashill By) Co. Offaly.

A Chara,

I, Eoghan Byrne, confirm that I am the owner of the lands identified on the map comprising Folio(s) OY12878 attached to this letter and that I am aware of and consent to the application by Ballinla Wind Farm Limited for planning permission for a renewable energy project including enabling works to facilitate turbine deliveries on lands in the townlands of Leitrim, Ballyleakin, Ballyfore Big, and Ballina (Geashill By) Co. Offaly.

The proposed works are described in the plans and particulars which are to be submitted with the planning application.

I confirm that I have been shown a map of the proposed turbine locations and works to be completed on my lands. I am supportive of the development of the project.

Yours sincerely,



Eoghan Byrne

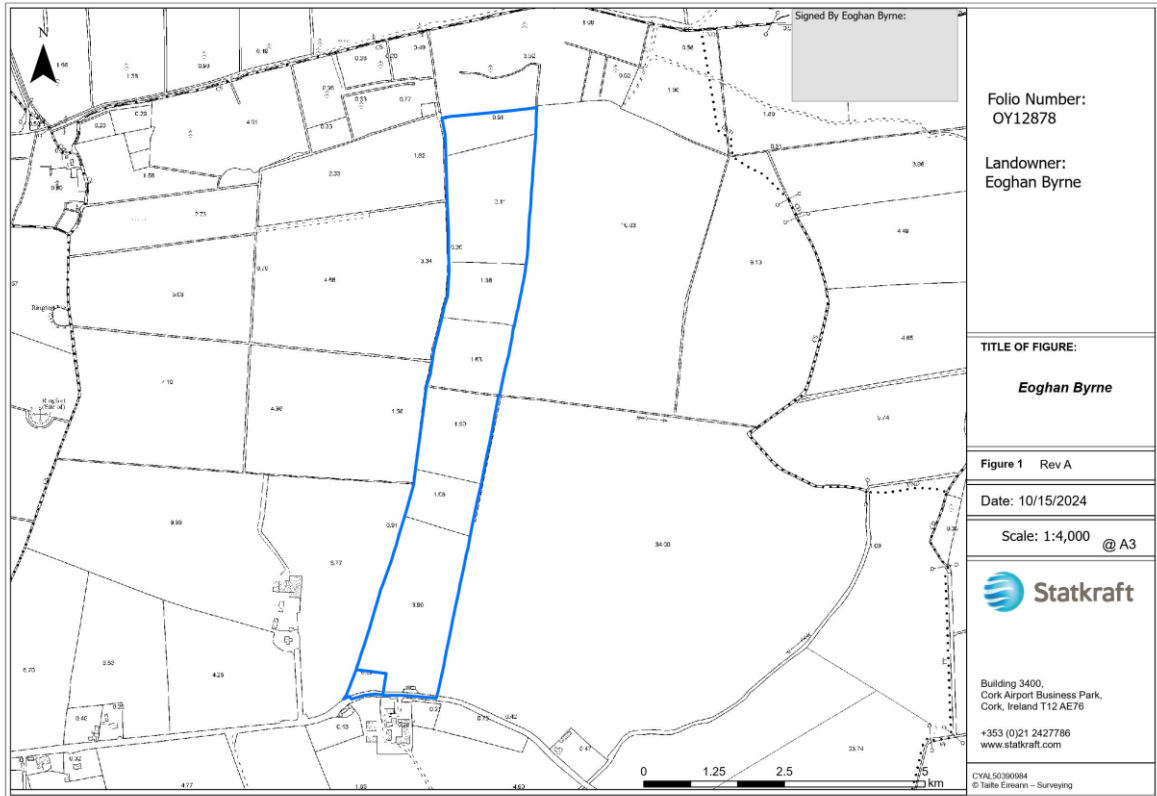

Eugene Byrne,
Leitrim,
Edenderry,
Co. Offaly

POSTAL ADDRESS
Building 3400,
Cork Airport Business
Park,
Rathmacullig West
Cork
T12 AE76

PHONE
(021) 242 7786

INTERNET
www.statkraft.ie

EMAIL
post@statkraft.com

Date: 06/05/25

Re: Planning application by Ballinla Wind Farm Limited, Proposed Renewable Energy Project on lands in the townlands of Leitrim, Ballyleakin, Ballyfore Big, and Ballina Co. Offaly

A Chara,

I, Eugene Byrne confirm that I am the owner of the lands identified on the map attached to this letter and I am aware of the application by Ballinla Wind Farm Limited for planning permission for a renewable energy project on townlands at Leitrim, Ballyleakin, Ballyfore Big, and Ballina (Geashill By) Co. Offaly.

The proposed works are described in the plans and particulars which are to be submitted with the planning application.

I confirm that I have been shown a map of the of the proposed turbine locations and works to be completed adjacent to our lands and are fully supportive of the development of the project.

Further, I have been made aware of the potential impacts of the proposed wind farm, in particular those relating to visual, noise, and shadow flicker. I fully accept any impacts from the turbines erected as part of this project.

Yours sincerely,

Eugene Byrne

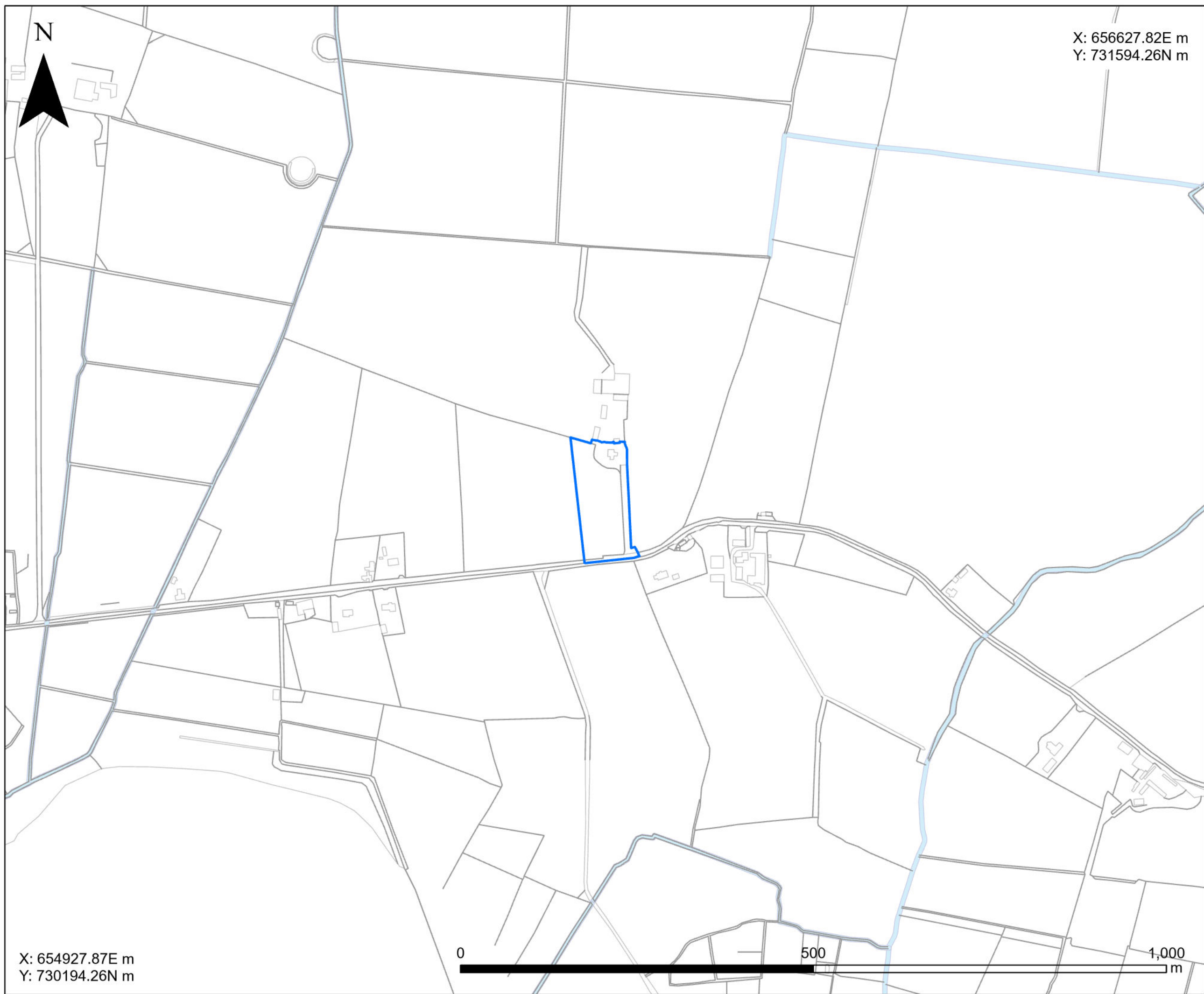

X: 654927.87E m
Y: 730194.26N m

X: 656627.82E m
Y: 731594.26N m



Location Map
Folio - OY13509

Coordinate System: IREN95 Irish Transverse Mercator
Projection: Transverse Mercator
Datum: IREN95
False Easting: 600,000.00
False Northing: 750,000.00
Central Meridian: -8.00
Scale Factor: 1.00
Latitude Of Origin: 53.50
Units: Meter
ITM Centre Point of Map
X: 655777.85E m
Y: 730894.26N m



Folio No: OY13509
Townland: Leitrim
County: Offaly

SCALES:
1:5,000 @ A3

"Map produced by Statkraft Ireland Limited.
This map is proprietary and confidential and must not be duplicated or distributed by any means without the express permission of Statkraft Ireland Limited
This map is digitally created based on information obtained from various sources. Statkraft Ireland Limited does not represent or warrant that the map is accurate, up to date, exhaustive or complete
Whilst every reasonable care has been taken to ensure the information is correct at the time of publication Statkraft Ireland Limited has no liability whatsoever, direct or indirect to any person for any loss or damage as a result of the use by any person of, or reliance upon, this map, or as a result of any errors, inaccuracies or omissions contained in this map.
No responsibility is accepted for any inaccuracies and/or new developments occurring within the mapped area"

Prepared By: Jason Dunne
Checked By: David O'Leary
Approv. By: Andrew Byrne
Path: X:\Ireland\Onshore
Ireland\Projects\Ballinla\Ballinla_Working_20241009\OY13509_Byrne_Location_Map

Date: 6/6/2025

CYAL50460632
© Tailte Éireann – Surveying

Fergus Malone,
Leitrim,
Edenderry,
Co. Offaly

POSTAL ADDRESS:
Building 3400
Avenue 3000
Cork Airport Business Park
Cork
Ireland
T12 AE76

Date:

To whom it may concern:

Re: Letter of Consent for the proposed interconnector cable as part of the Ballinla Wind Farm Development in the townlands of Ballyleakin, Ballyfore Big, and Ballina (Geashill By) Co. Offaly.

Applicant: Ballinla Wind Farm Limited

I, Fergus Malone confirm that I am the owner of the lands identified on the map comprising Folio(s) OY1449F – I am aware of and consent to the proposed works by Ballinla Wind Farm Limited for planning permission for a renewable energy project which includes enabling works to facilitate an interconnector cable on lands in the townlands of Leitrim, Ballyleakin, Ballyfore Big, and Ballina (Geashill By) Co. Offaly.

The proposed works are described in the plans and particulars which are to be submitted with the planning application.

I confirm that I have been shown a map of the proposed works to be completed on my lands to facilitate the laying of the interconnector cable associated with the wind farm project and I am supportive of the development of the project.

Yours Sincerely,

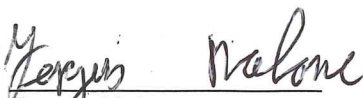
Fergus Malone

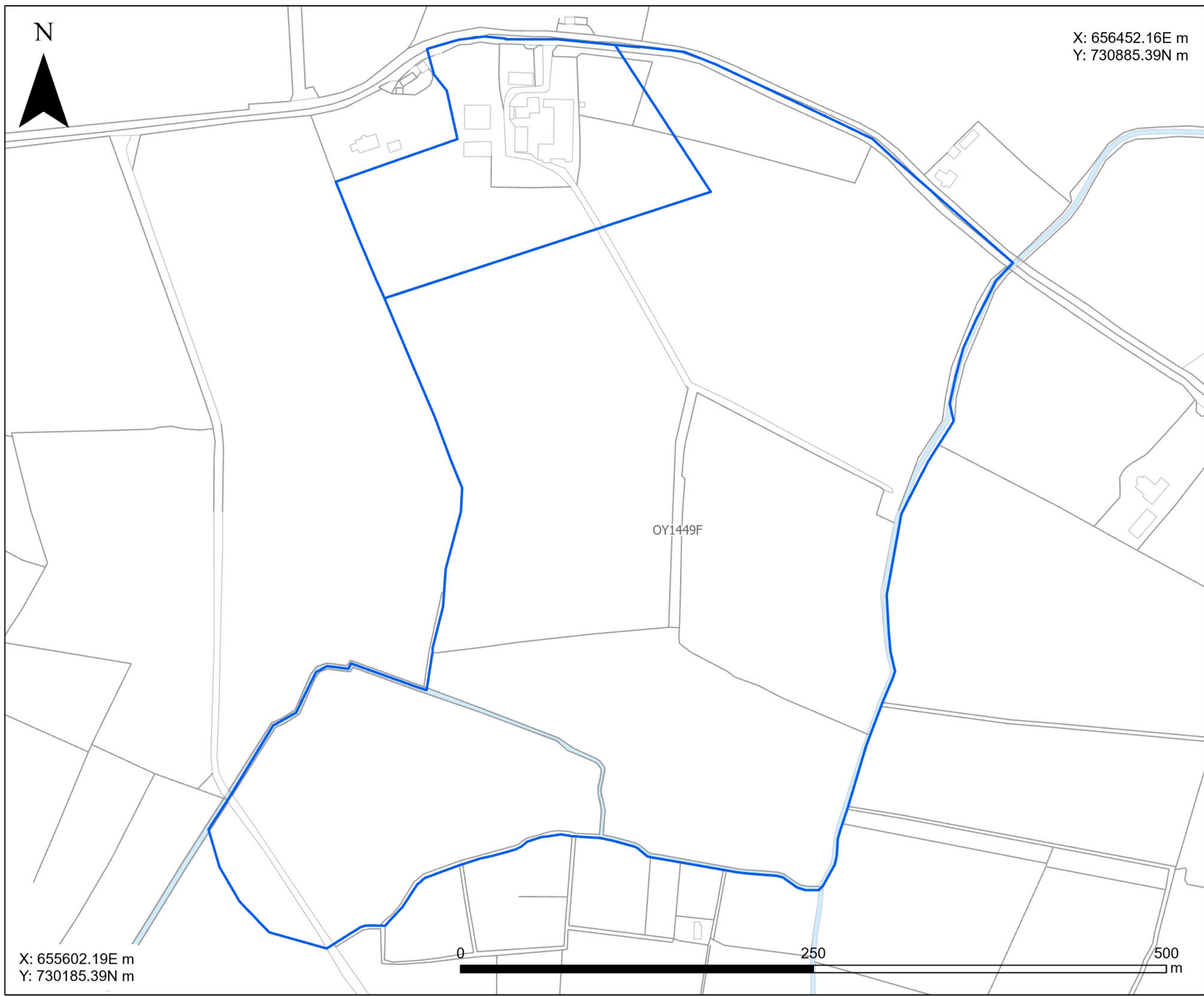

X: 656452.16E m
Y: 730885.39N m



Folio - OY1449F
Part 1 of 1

Coordinate System: IRENET95 Irish Transverse Mercator
Projection: Transverse Mercator
Datum: IRENET95
False Easting: 600,000.00
False Northing: 750,000.00
Central Meridian: -8.00
Scale Factor: 1.00
Latitude Of Origin: 53.50
Units: Meter
ITM Centre Point of Map
X: 656027.18E m
Y: 730535.39N m

Signed By Fergal Malone:

 Folio

Folio No: OY1449F
Townland: Leitrim
County: Offaly

SCALES: 1:2,500 @ A3

"Map produced by Statkraft Ireland Limited.
This map is proprietary and confidential and must not be duplicated or distributed by any means without the express permission of Statkraft Ireland Limited
This map is digitally created based on information obtained from various sources. Statkraft Ireland Limited does not represent or warrant that the map is accurate, up to date, exhaustive or complete
Whilst every reasonable care has been taken to ensure the information is correct at the time of publication Statkraft Ireland Limited has no liability whatsoever, direct or indirect to any person for any loss or damage as a result of the use by any person of, or reliance upon, this map, or as a result of any errors, inaccuracies or omissions contained in this map.
No responsibility is accepted for any inaccuracies and/or new developments occurring within the mapped area"

Prepared By: Jason Dunne
Checked By: David O'Leary
Approv. By: Andrew Byrne
Path: X:\Ireland\Onshore
Ireland\Projects\Ballinla\Ballinla_Working_20241009\OY1449F_Malone_Consent_Map

Date: 7/7/2025

CYAL50460632
© Tailte Éireann – Surveying

X: 655602.19E m
Y: 730185.39N m



Joan Hernon,
2 Willow Bank,
Blacklion,
Greystones,
Co. Wicklow

POSTAL ADDRESS
Building 3400,
Cork Airport Business Park,
Rathmacullig West
Cork
T12 AE76

PHONE
(021) 242 7786

INTERNET
www.statkraft.ie

EMAIL
post@statkraft.com

Date:

Re: Planning Application by Ballinla Wind Farm Limited for a Renewable Energy Project on lands in the townlands of Leitrim, Ballyleakin, Ballyfore Big, and Ballina (Geashill By) Co. Offaly.

A Chara,

I, Joan Hernon, confirm that I am the owner of the lands identified on the map comprising Folio(s) OY7044F attached to this letter and that I am aware of and consent to the application by Ballinla Wind Farm Limited for planning permission for a renewable energy project including enabling works to facilitate turbine deliveries on lands in the townlands of Leitrim, Ballyleakin, Ballyfore Big, and Ballina (Geashill By) Co. Offaly.

The proposed works are described in the plans and particulars which are to be submitted with the planning application.

I confirm that I have been shown a map of the proposed turbine locations and works to be completed on my lands. Further, I am supportive of the development of the project.

Yours sincerely,

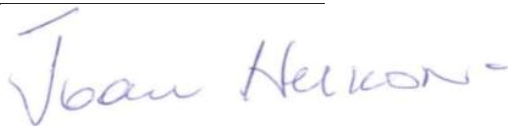

Joan Hernon

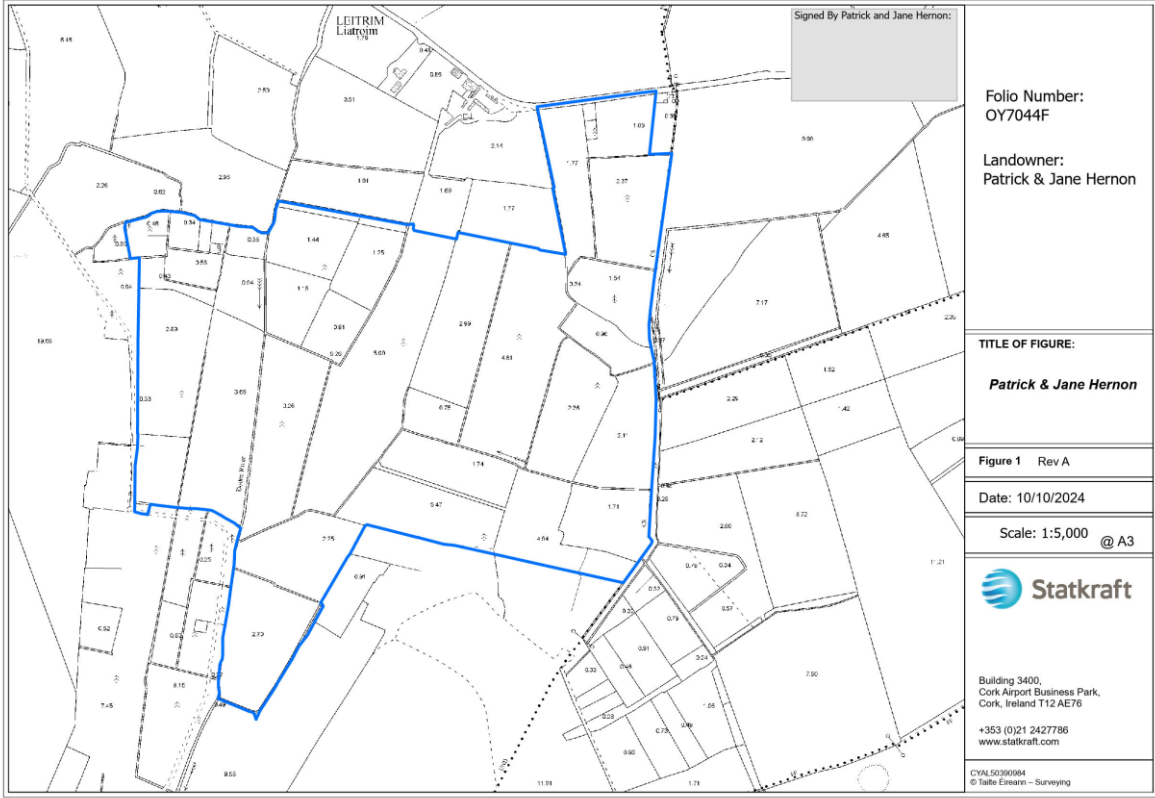

John Bosco Guinan,
Ballinla,
Geashill,
Co. Offaly,
R35 RF10

POSTAL ADDRESS
Building 3400,
Cork Airport Business Park,
Rathmacullig West
Cork
T12 AE76

PHONE
(021) 242 7786

INTERNET
www.statkraft.ie

EMAIL
post@statkraft.com

Date:

Re: Planning Application by Ballinla Wind Farm Limited for a Renewable Energy Project on lands in the townland of Leitrim, Ballyleakin, Ballyfore Big, and Ballina (Geashill By) Co. Offaly.

A Chara,

I, John Bosco Guinan confirm that I am the owner of the lands identified on the map comprising Folio(s) OY8123 - Plan no. DR1JD attached to this letter and that I am aware of and consent to the application by Ballinla Wind Farm Limited for planning permission for a renewable energy project including enabling works to facilitate turbine deliveries on lands in the townlands of Leitrim, Ballyleakin, Ballyfore Big, and Ballina (Geashill By) Co. Offaly.

The proposed works are described in the plans and particulars which are to be submitted with the planning application.

I confirm that I have been shown a map of the proposed works to be completed on my lands to facilitate turbine deliveries associated with the wind farm project and I am supportive of the development of the project.

Yours Sincerely,

John Bosco Guinan

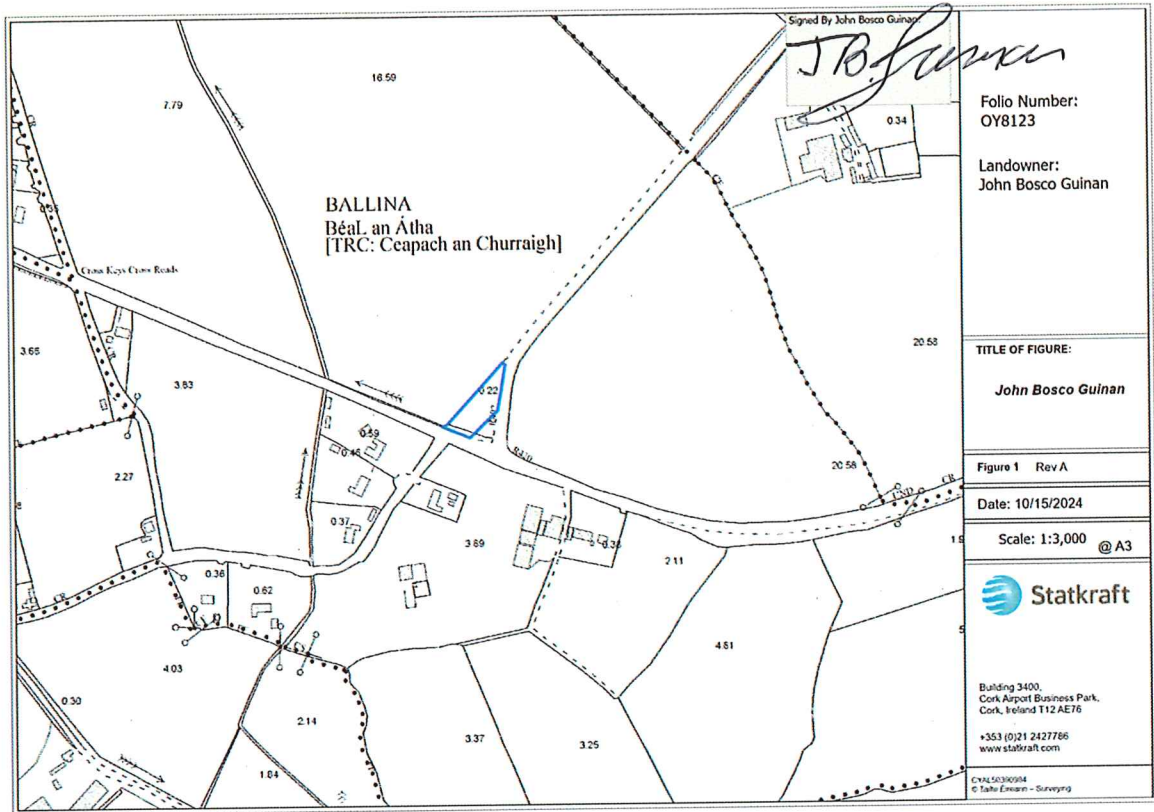

Barry Liffey,
Liffey Mills,
Bunnow,
Clybanane,
Roscrea,
Co. Tipperary

POSTAL ADDRESS
Building 3400,
Cork Airport Business Park,
Rathmacullig West
Cork
T12 AE76

PHONE
(021) 242 7786

INTERNET
www.statkraft.ie

EMAIL
post@statkraft.com

Date:

Re: Planning Application by Ballinla Wind Farm Limited for a Renewable Energy Project on lands in the townlands of Leitrim, Ballyleakin, Ballyfore Big, and Ballina (Geashill By) Co. Offaly.

A Chara,

I, Barry Liffey confirm that I am the owner of the lands identified on the map comprising Folio(s) OY7534 - Plan 19 attached to this letter and that I am aware of and consent to the application by Ballinla Wind Farm Limited for planning permission for a renewable energy project including enabling works to facilitate turbine deliveries on lands in the townlands of Leitrim, Ballyleakin, Ballyfore Big, and Ballina (Geashill By) Co. Offaly.

The proposed works are described in the plans and particulars which are to be submitted with the planning application.

I confirm that I have been shown a map of the proposed works to be completed on my lands to facilitate turbine deliveries associated with the wind farm project and I am supportive of the development of the project.

Yours Sincerely,

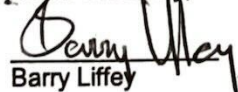
Barry Liffey

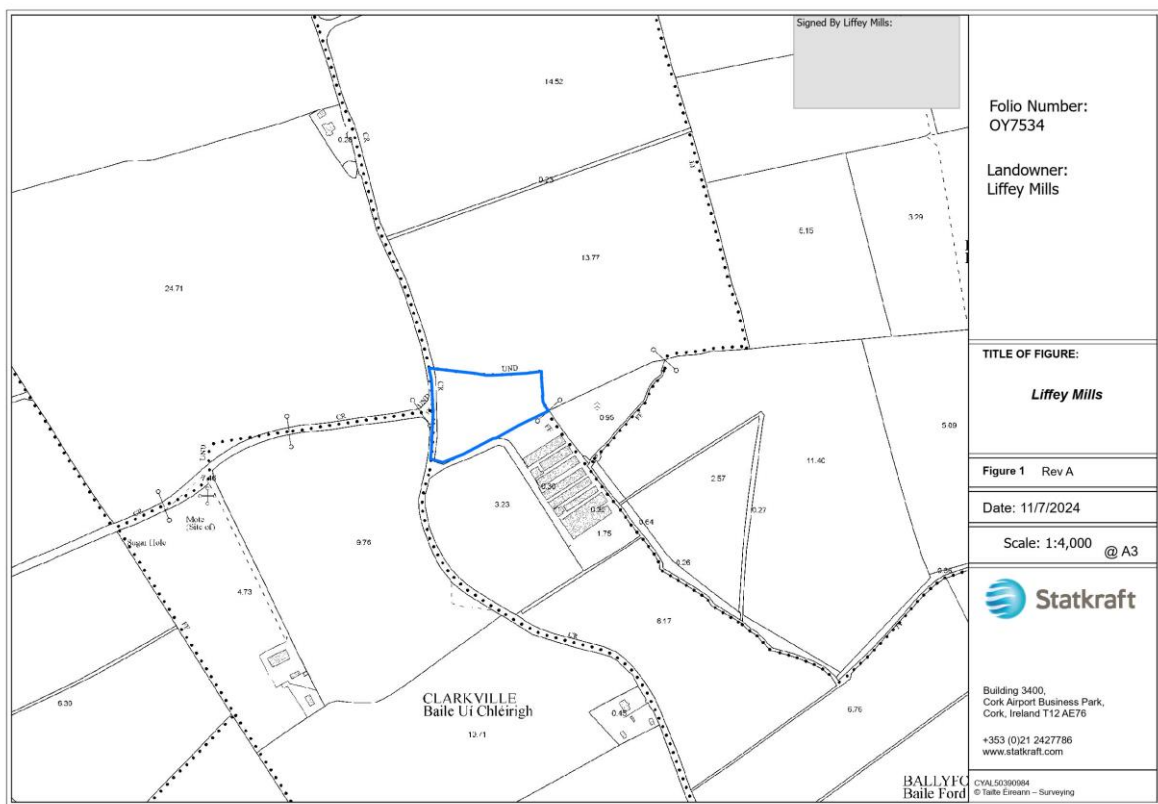

Mark Rochford,
Ballinla Dairy Farm,
Ballinla,
Edenderry,
Co. Offaly

POSTAL ADDRESS
Building 3400,
Cork Airport Business Park,
Rathmacullig West
Cork
T12 AE76

PHONE
(021) 242 7786

INTERNET
www.statkraft.ie

EMAIL
post@statkraft.com

Date:

Re: Planning Application by Ballinla Wind Farm Limited for a Renewable Energy Project on lands in the townlands of Leitrim, Ballyleakin, Ballyfore Big, and Ballina (Geashill By) Co. Offaly.

A Chara,

I, Mark Rochford, confirm that I am the owner of the lands identified on the map comprising Folio(s) OY11959 & OY17401F attached to this letter and that I am aware of and consent to the application by Ballinla Wind Farm Limited for planning permission for a renewable energy project including enabling works to facilitate turbine deliveries on lands in the townlands of Leitrim, Ballyleakin, Ballyfore Big, and Ballina (Geashill By) Co. Offaly.

The proposed works are described in the plans and particulars which are to be submitted with the planning application.

I confirm that I have been shown a map of the proposed turbine locations and works to be completed on my lands. I am supportive of the development of the project.

Yours sincerely,



Mark Rochford

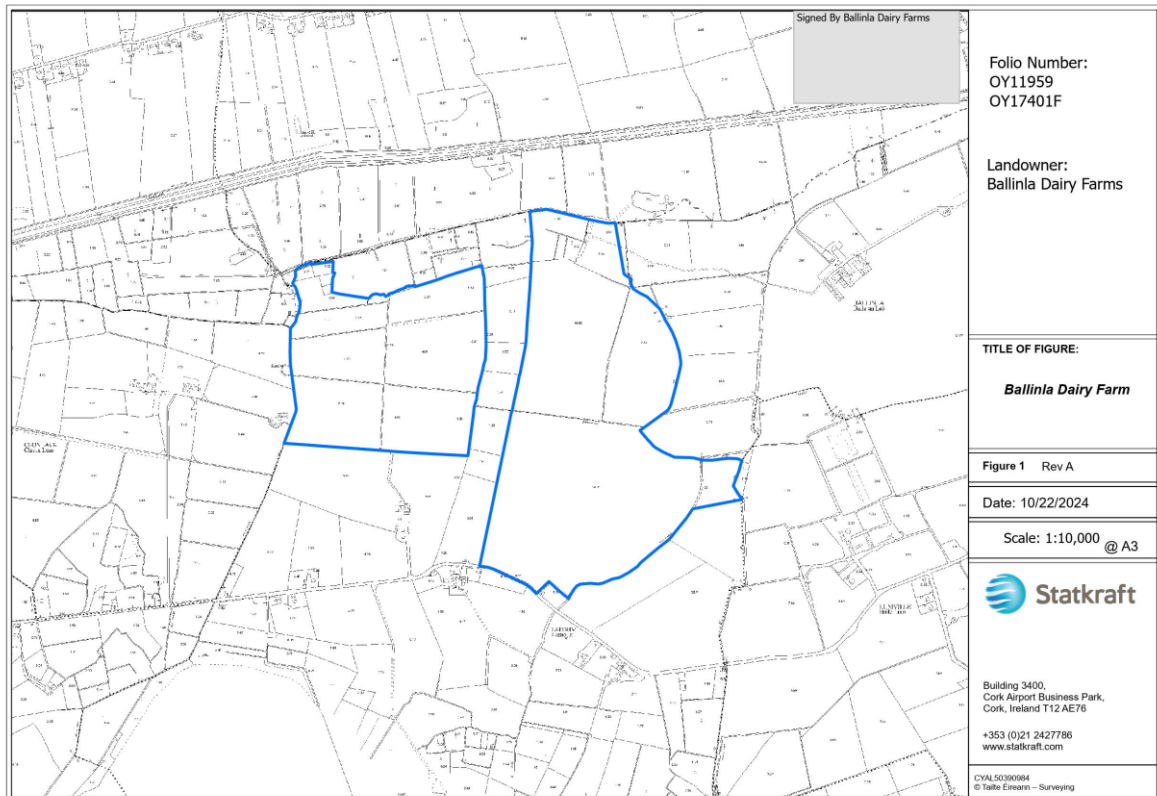



Nigel Beattie,
Ballyleakin,
Edenderry,
Co. Offaly

POSTAL ADDRESS
Building 3400,
Cork Airport Business Park,
Rathmacullig West,
Cork
T12 AE76

PHONE
(021) 242 7786

INTERNET
www.statkraft.ie

EMAIL
post@statkraft.com

Date:

Re: Planning Application by Ballinla Wind Farm Limited for a Renewable Energy Project on lands in the townlands of Leitrim, Ballyleakin, Ballyfore Big, and Ballina (Geashill By) Co. Offaly.

A Chara,

I, Nigel Beattie confirm that I am the owner of the lands identified on the map comprising Folio(s) OY10116F – Plan 25 attached to this letter and that I am aware of and consent to the application by Ballinla Wind Farm Limited for planning permission for a renewable energy project including enabling works to facilitate turbine deliveries on lands in the townlands of Leitrim, Ballyleakin, Ballyfore Big, and Ballina (Geashill By) Co. Offaly.

The proposed works are described in the plans and particulars which are to be submitted with the planning application.

I confirm that I have been shown a map of the proposed works to be completed on my lands to facilitate turbine deliveries associated with the wind farm project and I am supportive of the development of the project.

Yours Sincerely,

A handwritten signature in blue ink, appearing to read "Nigel Beattie", written over a horizontal line.

Nigel Beattie

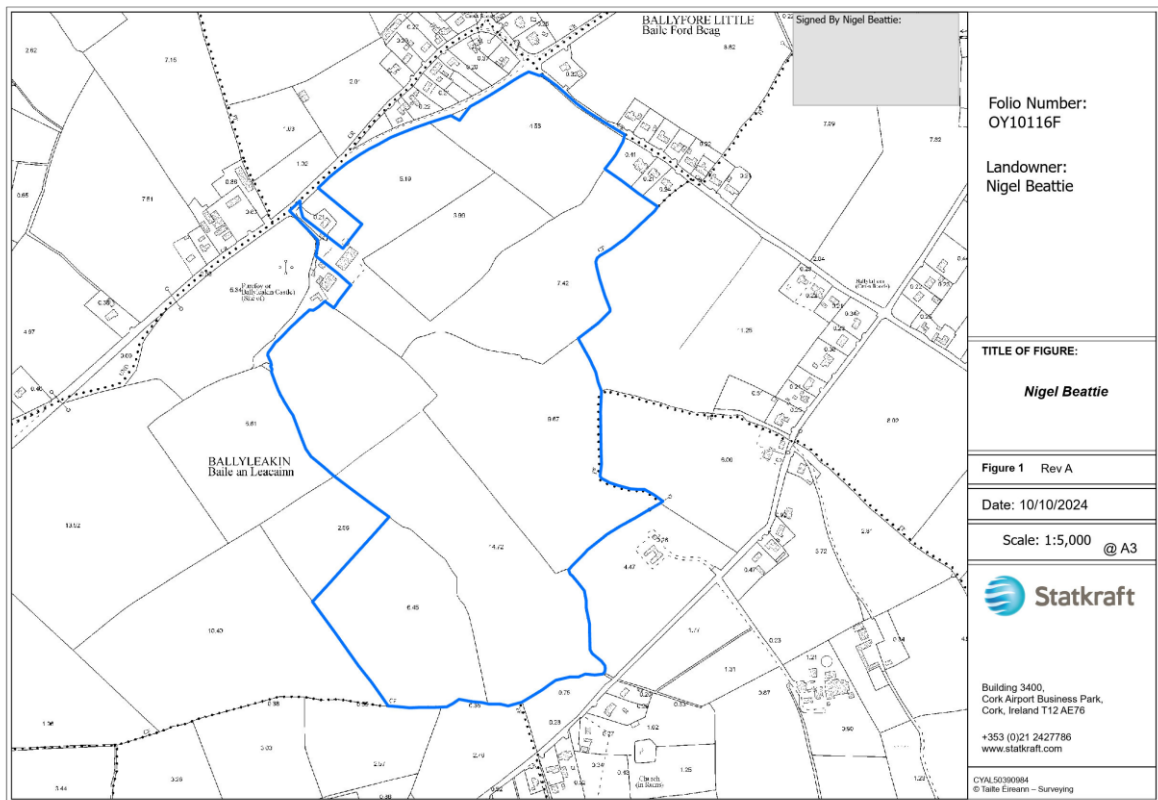

SID Department
An Coimisiún Pleanála
64 Marlborough Street
Dublin
D01 V902

Our Ref: CLS_ACP_LTR_670

24th July 2025

Re: Letter of Consent regarding the Planning Application by Ballinla Wind Farm Limited for Ballinla Wind Farm as relates to sections of Coillte CGA's Leitrim property in Co. Offaly

Dear Sir/Madam,

This letter refers to the estate, right and title of Coillte CGA in the property known as Leitrim which property is outlined in red on the indicative Map attached hereto (hereinafter called "**the Property**").

We refer to the proposal by Ballinla Wind Farm Limited to locate 2 turbines and associated roading requirements on the Property as part of the Ballinla Wind Farm. The proposed locations of the above as it concerns the Property are shown on the Map attached hereto. We wish to advise that we have no objection in principle to the submission of a planning application which solely relates to the proposal to locate 2 turbines and associated roading requirements on the Property in the manner illustrated in the Map attached hereto and hereby furnish this letter for the purposes of consent only to the submission of this application by Ballinla Wind Farm Limited.

Please note that this letter is not and shall not constitute a note or memorandum in writing for the purposes of Section 51 of the Land and Conveyancing Law Reform Act, 2009.

We trust you will find the above in order. Should you have further queries, please do not hesitate to contact us.

Yours faithfully,

Ashley Culbert
Coillte CGA

Coillte, Dublin Road, Newtownmountkenny, Co. Wicklow, A63 DN25, Ireland.

T 0818 367 378 E info@coillte.ie W www.coillte.ie

Map illustrating proposed location of turbines and roading requirements as they concern Coillte Property (lands outlined in red) as part of the overall Ballinla Wind Farm proposal



Coillte Location Map

Coordinate System: IRENET95 Irish Transverse Mercator
 Projection: Transverse Mercator
 Datum: IRENET95
 False Easting: 600,000.00
 False Northing: 750,000.00
 Central Meridian: -8.00
 Scale Factor: 1.00
 Latitude Of Origin: 54.50
 Units: Meter
 ITM Centre Point of Map
 X: 656306.05E m
 Y: 730340.78N m

© OpenStreetMap (and) contributors, CC-BY-SA

- Proposed Turbine
- Private Landowners
- Coillte
- Proposed Substation
- Proposed Roads

Folio No: Various
 Townland: Leitrim
 County: Offaly

SCALES:
 1:14,000 @ A3

*Map produced by Statkraft Ireland Limited
 This map is proprietary and confidential and must not be duplicated or distributed by any means without the express permission of Statkraft Ireland Limited.
 This map is digitally created based on information obtained from various sources. Statkraft Ireland Limited does not represent or warrant that the map is accurate, up to date, exhaustive or complete.
 Whilst every reasonable care has been taken to ensure the information is correct at the time of publication Statkraft Ireland Limited does not hold any responsibility, direct or indirect to any person for any loss or damage as a result of the use by any person of, or reliance upon, this map, or as a result of any errors, inaccuracies or omissions contained in this map.
 No responsibility is accepted for any inaccuracies and/or new developments occurring within the mapped area.

Prepared By: Jason Dunne
 Checked By: David O'Leary
 Approved By: Andrew Byrne
 Path: X:\Ireland\Onshore
 Ireland\Projects\Ballinla\Ballinla_Working_20241009\
 Coillte_Location_Map

Date: 6/6/2025

CYAL50460632
 © Tailte Éireann – Surveying

Folio	Property
OY12878	
OY12878	
OY1449F	
OY1449F	
OY7044F	1
OY28729F	1
OY17401F	1
OY11959	1